

DENTAL & MEDICAL STOOL

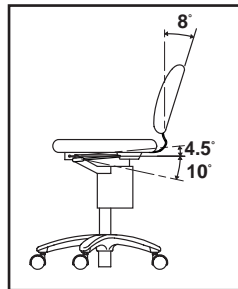

DX-004D

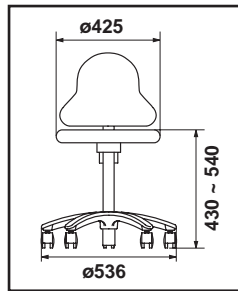

Specifications

Lifting Stroke --- 110 mm

Net Weight ----- 14 kg

Tilting Angle ---- 14.5° (forward 4.5°)

Upholstery Choices --- CG / MR / UT

- Seat height and tilt adjustment by gas cylinder.
- Smooth and light seat height and tilt adjustment by hand lever.
- Seat and backrest tilt forward together for relaxed lumbar support and comfort.
- 5 leg, cast aluminum base provides maximum stability.

DX-002K

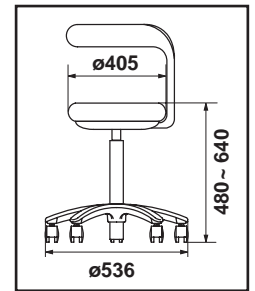

Specifications

Lifting Stroke --- 160 mm

Net Weight ----- 14 kg

Upholstery Choices --- CG / MR / UT

- Seat height adjustment by gas cylinder.
- Ring lever is located under the seat, and smooth and light in adjustment.
- Fixed backrest for added stability, and can be used as an armrest.
- Extra thick cushion for comfort.
- 5 leg, cast aluminum base provides maximum stability.

DX-004A

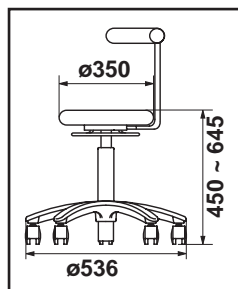

Specifications

Lifting Stroke --- 195 mm

Net Weight ----- 10 kg

Upholstery Choices --- CG / MR

- Seat height adjustment by gas cylinder.
- Easily reachable seat height adjustment by ring lever.
- 360°rotatable backrest.
- 5 leg, cast aluminum base provides maximum stability.
- Footrest ring for comfort (optional).

DX-002N

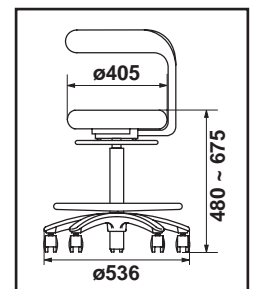

Specifications

Lifting Stroke --- 195 mm

Net Weight ----- 16 kg

Upholstery Choices --- CG / MR / UT

- Seat height adjustment by gas cylinder.
- Easily reachable seat height adjustment by ring lever.
- Fixed backrest for added stability, and can be used as an armrest.
- Extra thick cushion for comfort.
- Footrest ring for comfort.
- 5 leg, cast aluminum base provides maximum stability.

DH-007N

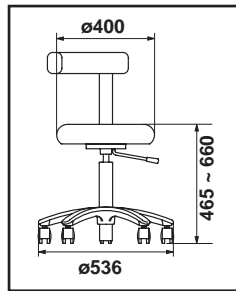

Specifications

Lifting Stroke --- 195 mm

Net Weight ----- 10 kg

Upholstery Choices --- TS, (UT) *

* (UT) stitches are apparent on the surface.

- Seat height adjustment by gas cylinder.
- Smooth and light seat height adjustment by hand lever.
- Fixed backrest for added stability.
- 5 leg, cast aluminum base provides maximum stability.

DH-009L

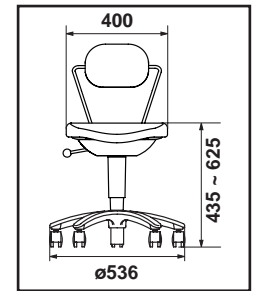

Specifications

Lifting Stroke --- 190 mm

Net Weight ----- 10 kg

Upholstery Choices --- CG / MR / CN

- Seat height and tilt adjustment by gas cylinder.
- Smooth and light seat height adjustment by hand lever.
- Two brake equipped casters to prevent inadvertent movement are released when seated.
- Seat ergonomically designed to fit females.
- Comfortably accommodates treatment with a forward-bent posture.

DH-008D

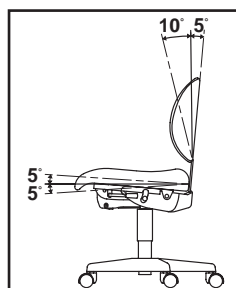
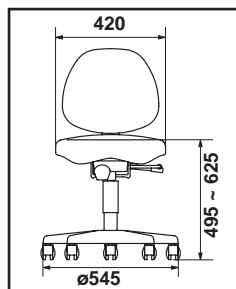

Specifications

Lifting Stroke --- 160 mm

Net Weight ----- 16 kg

Tilting Angle ---- 14.5° (forward 4.5°)

Upholstery Choices --- CG / MR / UT

- Seat height and tilt adjustment by gas cylinder.
- Smooth and light seat height and tilt adjustment by hand lever.
- Seat and backrest tilt forward together for relaxed lumbar support and comfort.
- Ergonomically contoured seat.

DH-008A

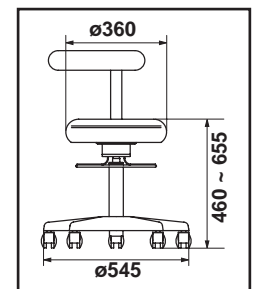

Specifications

Lifting Stroke --- 195 mm

Net Weight ----- 9.5 kg

Upholstery Choices --- CG / MR / UT

- Seat height adjustment by gas cylinder.
- Smooth and light seat height adjustment by hand lever.
- 360°rotatable backrest.
- Ergonomically contoured seat.

DR-009F Operating Stool



Backrest DR-BS
(Optional)

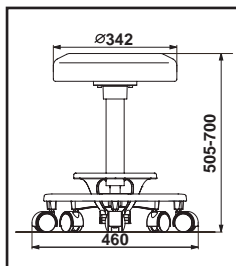

Specifications
Lifting Stroke ----- 195 mm
Net Weight -----
10kg (without backrest)
Upholstery Choices --- ES08

- Seat height adjustment by gas cylinder.
- Smooth and light seat height adjustment by ring lever.
- Highly stabilized and compact base for operating rooms and treatment rooms.
- Foot control keeps hands clean.

DR-007FS Operating Stool

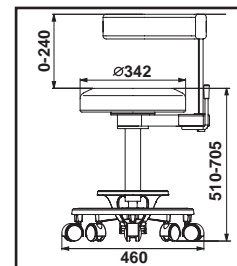

Specifications
Lifting Stroke ----- 195 mm
Net Weight ----- 13 kg
Upholstery Choices --- ES08

- Seat height adjustment by gas cylinder.
- Smooth and light seat height adjustment by ring lever.
- Highly stabilized and compact base for operating rooms and treatment rooms.
- 360°rotatable backrest and 250mm adjustable height for the ideal posture of the doctor.
- Foot control keeps hands clean.

DR-010DN

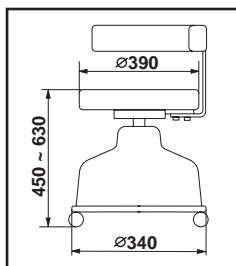

Specifications
Lifting Stroke ----- 180 mm
Net Weight ----- 29 kg
Rating Voltage -----
AC 110/ 220/ 230/ 240 V
Upholstery Choices --- 025

- Seat height adjustment by electro-hydraulic pump.
- Smooth and light seat height adjustment by pedal switch.
- Low initial height and height adjustment for the ideal posture of the doctor.

HY-1200 Operating Stool

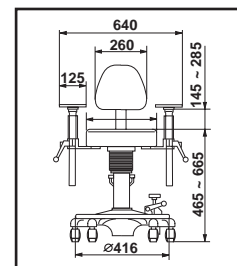

Specifications
Lifting Stroke ----- 200 mm
Net Weight ----- 27 kg
Upholstery Choices ----- M1

- Seat height adjustment by hydraulic pump.
- Height adjustable armrest with sliding movement.
- Foot control keeps hands clean.
- Stable and compact base for easy access to surgical areas.

HY-1100 Operating Stool

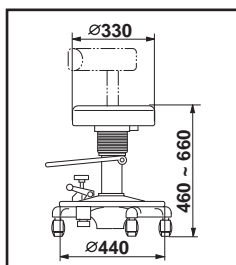

Specifications
Lifting Stroke ----- 200 mm
Net Weight ----- 18 kg
Upholstery Choices --- 025
Backrest ----- Option

- Seat height adjustment by hydraulic pump.
- Foot control keeps hands clean.
- Stable and compact base for easy access to surgical areas.

The manufacturer reserves the right to alter specifications without prior notice.

Belmont®

TAKARA BELMONT CORPORATION
2-1-1, Higashishinsaibashi,
Chuo-ku, Osaka, 542-0083, Japan
TEL : 81-6-6213-5945
FAX : 81-6-6212-3680

Book no. D-001
Printed in Japan 2009. 03